

DELTRIN® SPUR GEARS-HUBLESS

20° PRESSURE ANGLE QUALITY NO. 10

24 PITCH
3/16 FACE
3/8 BORE

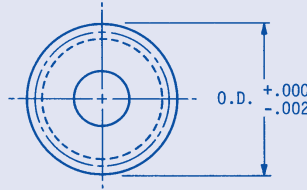
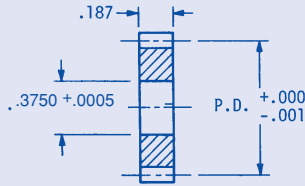

DUE TO THE INSTABILITY OF DELTRIN MATERIAL, NORDEX GUARANTEES DIMENSIONS AT THE TIME OF CUTTING ONLY.

ORDER BY CATALOG NUMBER

Cat. No.	No. of Teeth	P.D.	O.D.	Cat. No.	No. of Teeth	P.D.	O.D.
LQE-C3-15	15	.6250	.708	LQE-C3-36	36	1.5000	1.583
LQE-C3-16	16	.6667	.750	LQE-C3-40	40	1.6667	1.750
LQE-C3-17	17	.7083	.792	LQE-C3-42	42	1.7500	1.833
LQE-C3-18	18	.7500	.833	LQE-C3-45	45	1.8750	1.958
LQE-C3-19	19	.7917	.875	LQE-C3-46	46	1.9167	2.000
LQE-C3-20	20	.8333	.917	LQE-C3-48	48	2.0000	2.083
LQE-C3-21	21	.8750	.958	LQE-C3-50	50	2.0833	2.167
LQE-C3-22	22	.9167	1.000	LQE-C3-52	52	2.1667	2.250
LQE-C3-23	23	.9583	1.042	LQE-C3-55	55	2.2917	2.375
LQE-C3-24	24	1.0000	1.083	LQE-C3-56	56	2.3333	2.417
LQE-C3-25	25	1.0417	1.125	LQE-C3-57	57	2.3750	2.458
LQE-C3-28	28	1.1667	1.250	LQE-C3-60	60	2.5000	2.583
LQE-C3-30	30	1.2500	1.333	LQE-C3-64	64	2.6667	2.750
LQE-C3-32	32	1.3333	1.417	LQE-C3-66	66	2.7500	2.833
LQE-C3-33	33	1.3750	1.458	LQE-C3-69	69	2.8750	2.958

For unlisted number of teeth, please inquire for price.

DELTRIN® SPUR GEARS-HUBLESS

20° PRESSURE ANGLE QUALITY NO. 10

32 PITCH
3/16 FACE
3/8 BORE

ORDER BY CATALOG NUMBER

Cat. No.	No. of Teeth	P.D.	O.D.	Cat. No.	No. of Teeth	P.D.	O.D.
LQE-D3-20	20	.6250	.688	LQE-D3-48	48	1.5000	1.563
LQE-D3-21	21	.6563	.719	LQE-D3-50	50	1.5625	1.625
LQE-D3-22	22	.6875	.750	LQE-D3-52	52	1.6250	1.688
LQE-D3-23	23	.7188	.781	LQE-D3-56	56	1.7500	1.813
LQE-D3-24	24	.7500	.813	LQE-D3-60	60	1.8750	1.938
LQE-D3-25	25	.7813	.844	LQE-D3-63	63	1.9688	2.031
LQE-D3-26	26	.8125	.875	LQE-D3-64	64	2.0000	2.063
LQE-D3-28	28	.8750	.938	LQE-D3-66	66	2.0625	2.125
LQE-D3-30	30	.9375	1.000	LQE-D3-69	69	2.1563	2.219
LQE-D3-32	32	1.0000	1.063	LQE-D3-72	72	2.2500	2.313
LQE-D3-36	36	1.1250	1.188	LQE-D3-75	75	2.3438	2.406
LQE-D3-40	40	1.2500	1.313	LQE-D3-80	80	2.5000	2.563
LQE-D3-42	42	1.3125	1.375	LQE-D3-84	84	2.6250	2.688
LQE-D3-44	44	1.3750	1.438	LQE-D3-88	88	2.7500	2.813
LQE-D3-46	46	1.4375	1.500	LQE-D3-92	92	2.8750	2.938

For unlisted number of teeth, please inquire for price. DELTRIN® – Trademark E.I. DuPont Co.

NORDEX

(800) 243-0986 156L
In CT (203) 775-4877