

FLAT SPUR GEARS-HUBLESS

**80 PITCH
1/8 FACE
3/8 BORE**

Designed for use with:

- One way clutches (section "E")
- Cluster gears (section "L")
- Slip clutches (section "E")
- Pin hubs (section "B")
- Screw type hubs (section "B")
- Clamp type hubs (section "B")

Depending on application--
Nordex assembly charges on request.

**** NO LIGHTENING HOLES**

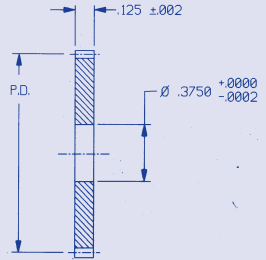
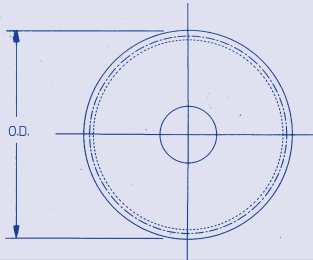

Specifications: Unless otherwise stated, 20° pressure angle, quality #10 or better gears will be supplied. When ordering Q12 or Q14 please supply the catalog number and add Q12 or Q14.

Gear Class	Total Composite Tolerance	Tooth to Tooth Composite Tolerance	Pitch Dia.	Outside Dia.
Q10	.001	.0004	-.001	-.002
Q12	.0005	.0003	-.0007	-.0015
Q14	.00025	.0002	-.0005	-.001

Gear tapes certifying accuracy available at additional cost.

ORDER BY CATALOG NUMBER

# 303 STAINLESS STEEL	2024-T4 ALUMINUM ANODIZED BEFORE CUTTING	GEAR DATA		
Cat. No.	Cat. No.	No. of Teeth	Pitch Diameter	Outside Diameter
LCS-H1-48	LCA-H1-48	48	.6000	.625
LCS-H1-50	LCA-H1-50	50	.6250	.650
LCS-H1-52	LCA-H1-52	52	.6500	.675
LCS-H1-54	LCA-H1-54	54	.6750	.700
LCS-H1-55	LCA-H1-55	55	.6875	.713
LCS-H1-60	LCA-H1-60	60	.7500	.775
LCS-H1-65	LCA-H1-65	65	.8125	.838
LCS-H1-70	LCA-H1-70	70	.8750	.900
LCS-H1-75	LCA-H1-75	75	.9380	.963
LCS-H1-80	LCA-H1-80	80	1.0000	1.025
LCS-H1-85	LCA-H1-85	85	1.0625	1.088
LCS-H1-90	LCA-H1-90	90	1.1250	1.150
LCS-H1-100	LCA-H1-100	100	1.2500	1.275
LCS-H1-110	LCA-H1-110	110	1.3750	1.400
LCS-H1-120	LCA-H1-120	120	1.5000	1.525
LCS-H1-127	LCA-H1-127	127	1.5875	1.613
LCS-H1-130	LCA-H1-130	130	1.6250	1.650
LCS-H1-140	LCA-H1-140	140	1.7500	1.775
LCS-H1-150	LCA-H1-150	150	1.8750	1.900
LCS-H1-160	LCA-H1-160	160	2.0000	2.025
LCS-H1-170	LCA-H1-170	170	2.1250	2.150
LCS-H1-180	LCA-H1-180	180	2.2500	2.275
LCS-H1-190	LCA-H1-190	190	2.3750	2.400
LCS-H1-200	LCA-H1-200	200	2.5000	2.525
LCS-H1-220	LCA-H1-220	220	2.7500	2.775

** LIGHTENING HOLES available upon request for gears 2 1/8 diameter and over. For hole specifications please refer to catalog number series KPS-J1 "Flat Gear Blanks" in section K.